

Your Futaba R7208SB/R7308SB programming can be updated easily online. When functions are improved, the update file can be downloaded from our website.

For more information, check out web site for FAQ regarding updating this product.

\*The display screen is an example. The screen depends on the PC.

## Required for update

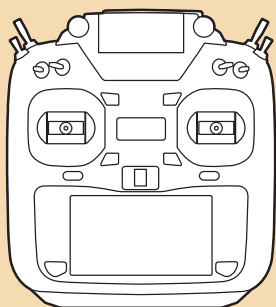

**T16IZ V4.0~  
T16IZ SUPER V2.0~**

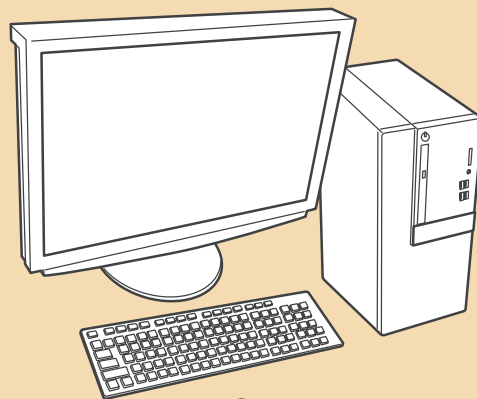

**PC**  
(Access is possible by the web)



**CGY750/GY701/GY520  
Extensions**



**microSD card**

## Updating procedure

1. Download the zip file of the update data from our website or your local distributor's website.

<http://www.rc.futaba.co.jp>

<https://futabausa.com>

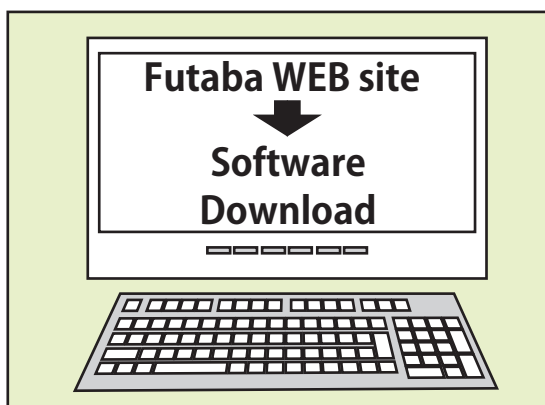

2. Extract the zip file on your computer.

3. "FUTABA" folder will be created.
4. Copy the "FUTABA" folder to micro SD card.
5. Connect as shown in the figure.

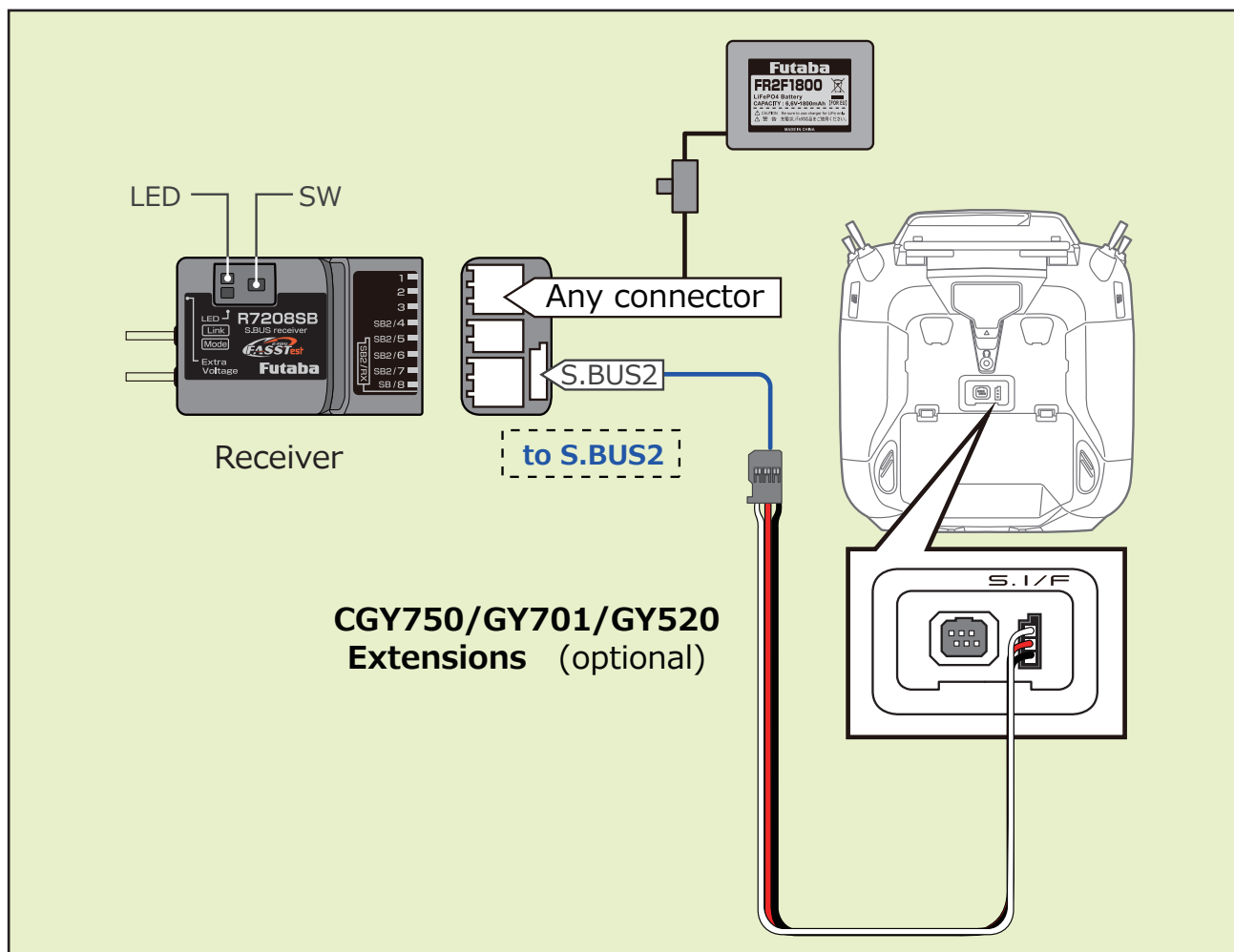

6. Insert the micro SD card with the "FUTABA" folder into the transmitter.

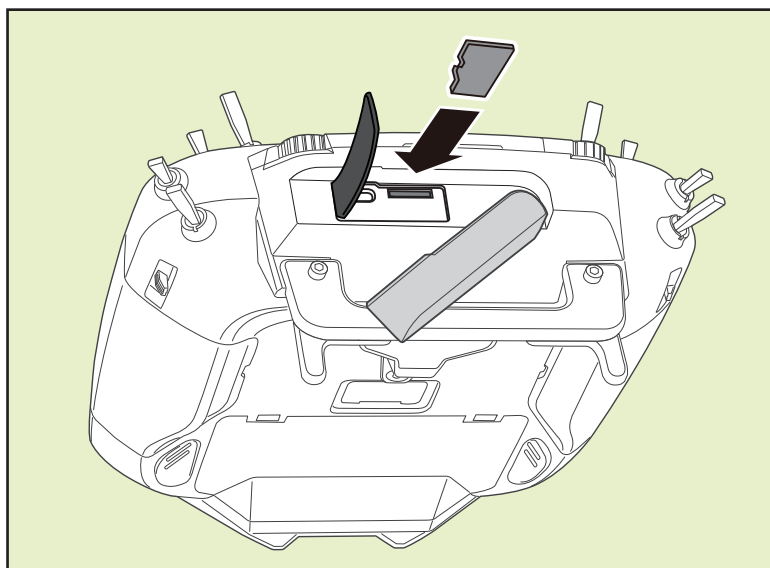

## 7. Turn on the power switch while pressing the U.MENU/MON button on the transmitter.

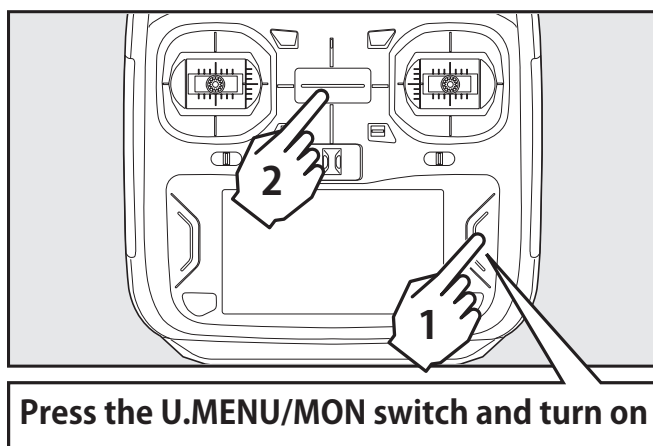

\*For safety reasons, receiver settings cannot be made while radio waves are being transmitted.

## 8. Transmitter menu : [System menu] ⇒ [Update] ⇒ [Receiver update] ⇒ [R7208SB]

\*The software of R7208SB and R7308SB is common. Tap R7208SB for R7308SB as well.

\*Update is not possible when CRSF is ON.

### T16IZ SUPER

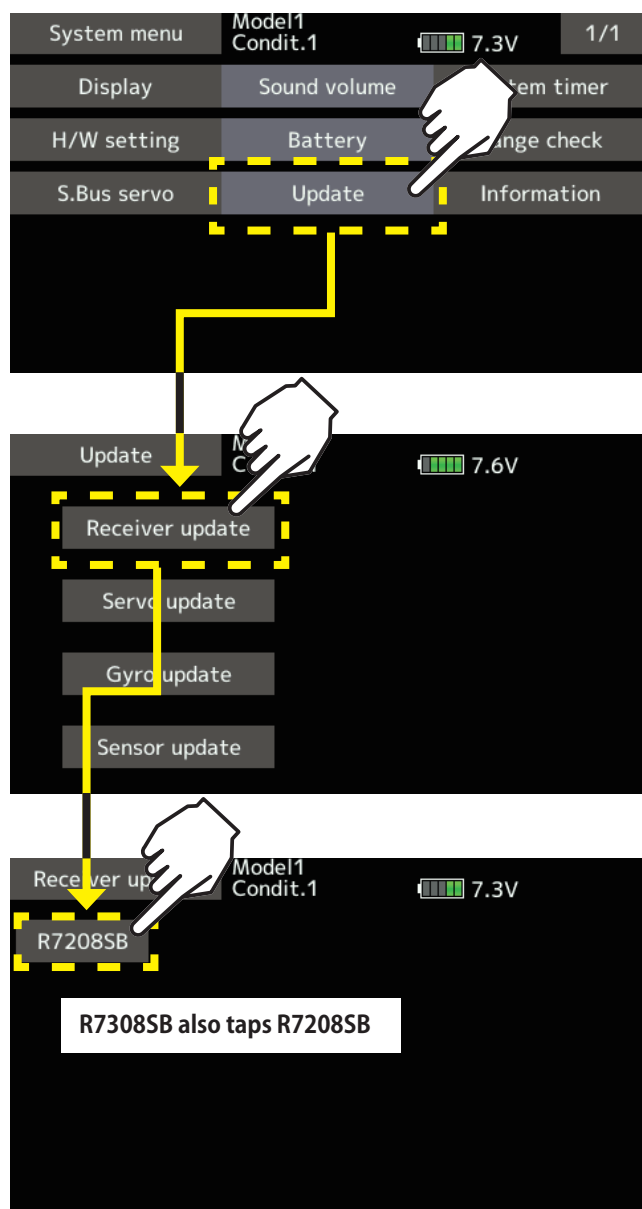

### T16IZ

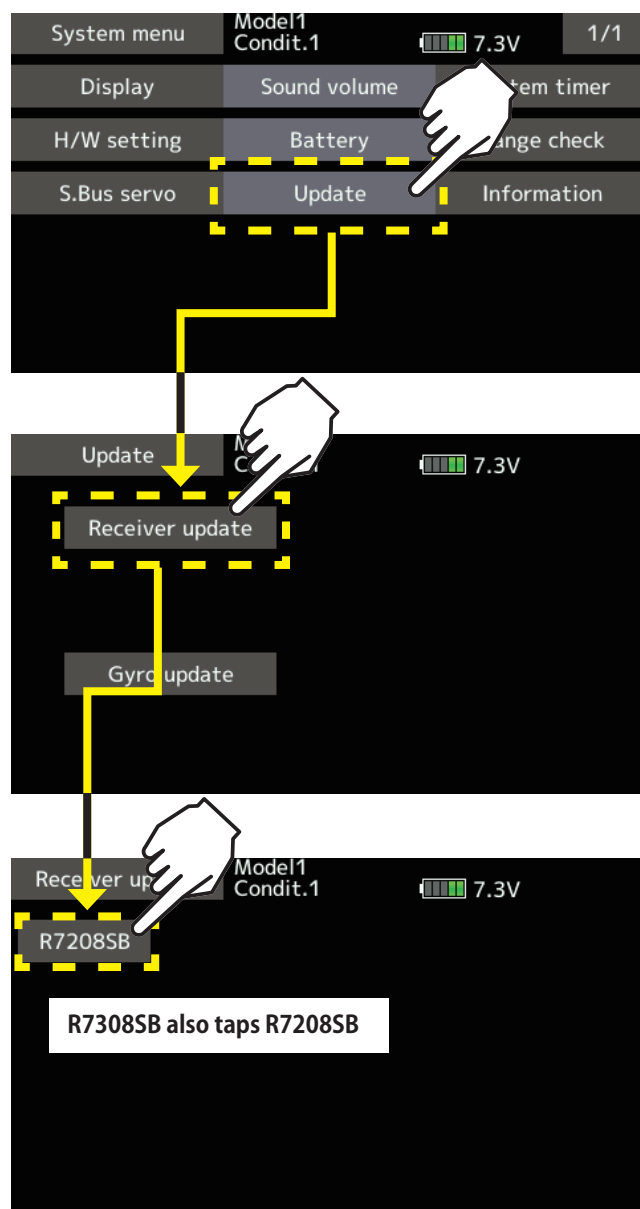

9. Turn on the receiver power while pressing down the switch.

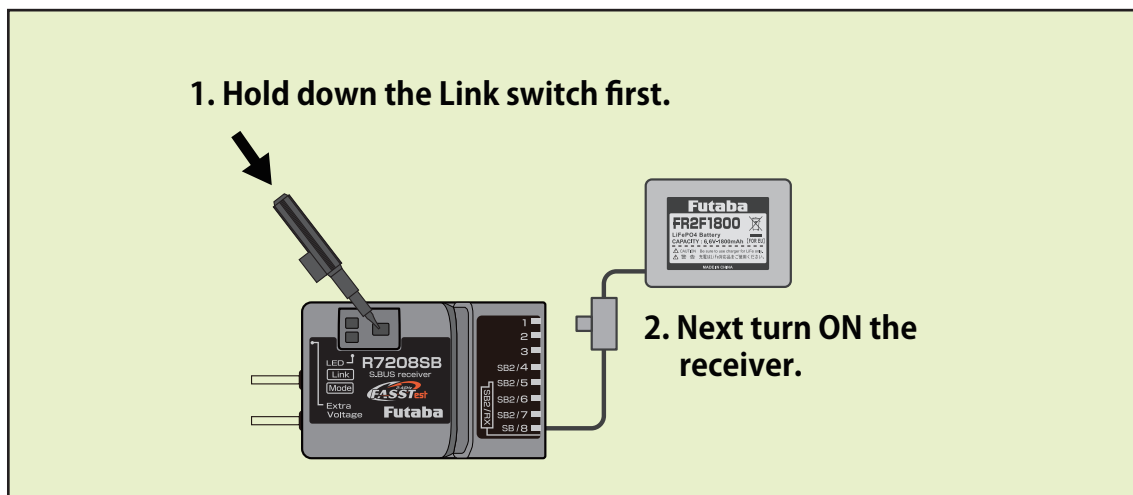

10. LED flash red once, release the switch.

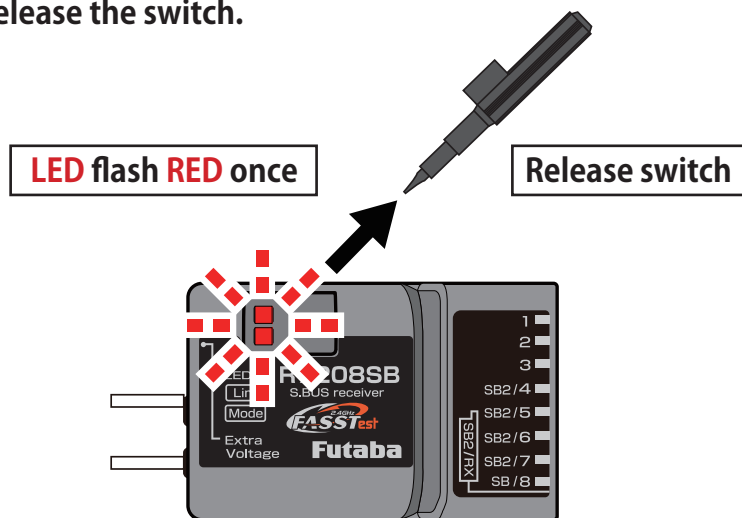

11. Press the switch again.

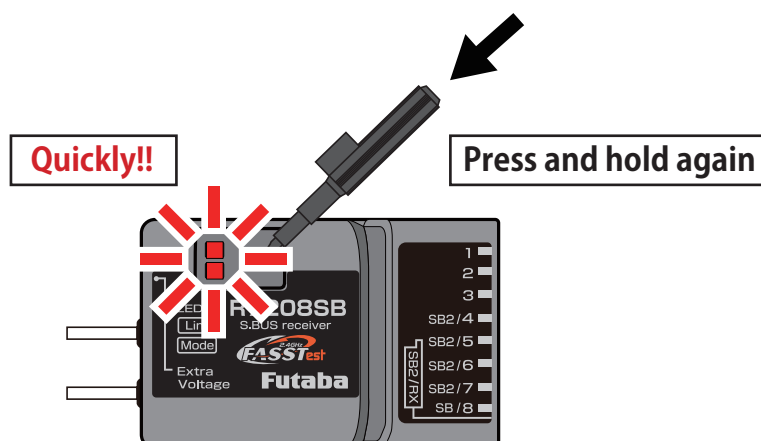

12. Release the switch when the solid orange.

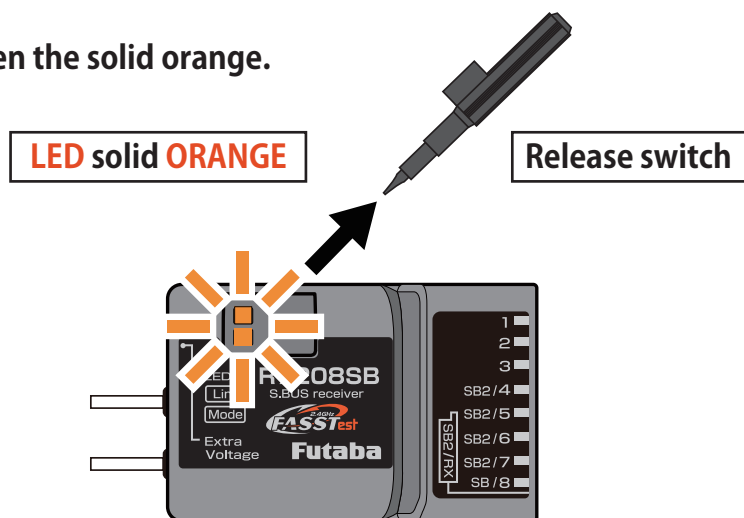

Receiver is waiting for update

13. Tap the Update button on the transmitter.



14. Update start.

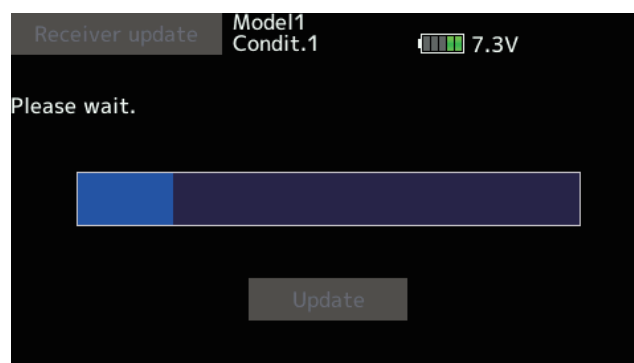

15. During the update, the update bar graph on the transmitter progresses and the green LED on the R7208SB/R7308SB flickers.

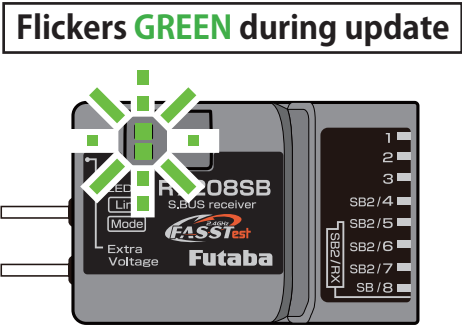

16. When the update is completed, the following display will appear.

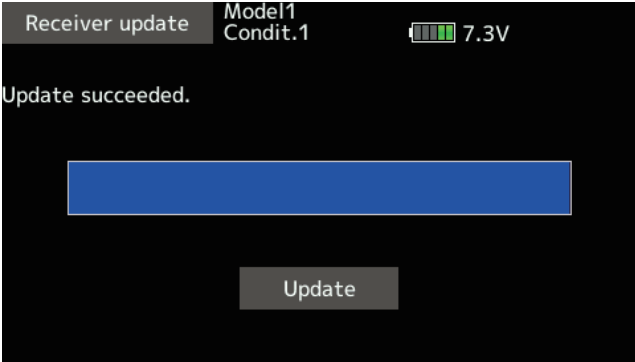

17. The GREEN LED on the R7208SB/R7308SB lights up when the update is complete.

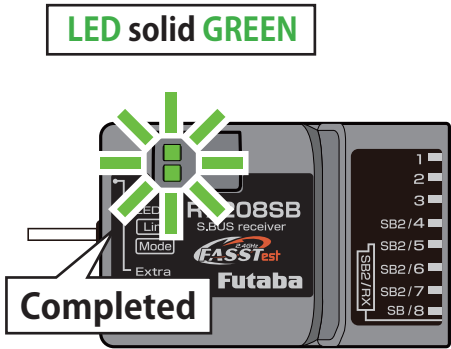

The following is how to check the receiver version. T16IZ can be checked from V6.0~, T16IZS from V4.0~.

18. Turn off the receiver and remove the battery.

The transmitter and receiver remain connected.

**\*To check the version, remove the battery.**

19. Tap [Receiver setting] on the System menu.

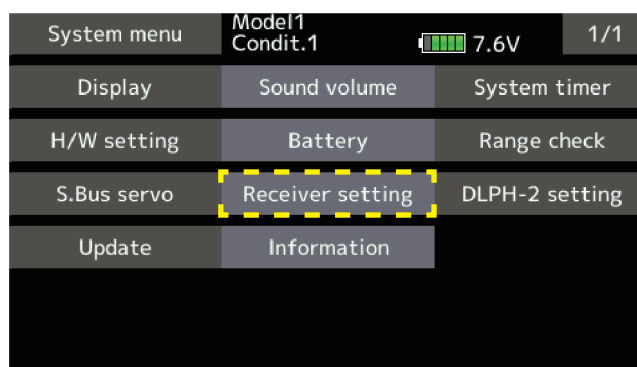

20. Tap [Read].

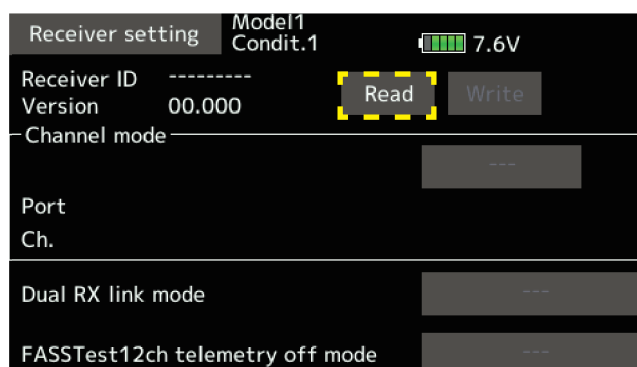

21. The version of the connected receiver will be displayed.

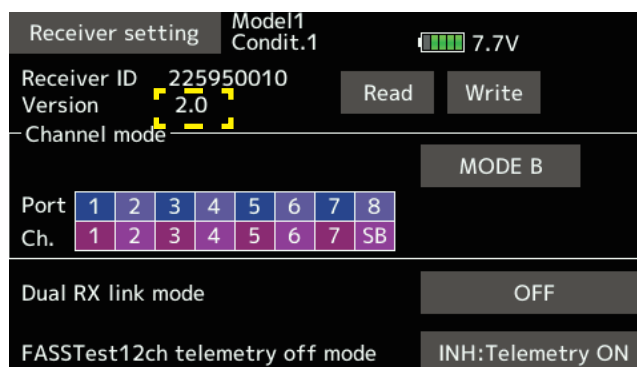

22. Turn off the power switch of receiver/transmitter and remove the connector.

23. Be sure to check the each function before use.

## V2.0 UPDATE

- Compatible with FASSTest26CH.
- Expanded CH mode (MODE H, I, J).

**R7208SB/R7308SB CH Mode table**

Output connector	Channel									
	Mode A	Mode B	Mode C	Mode D	Mode E	Mode F	Mode G	Mode H	Mode I	Mode J
1	1	1	1	1	9	9	9	17	17	17
2	2	2	2	2	10	10	10	18	18	18
3	3	3	3	3	11	11	11	19	19	19
SB2 / 4	4	4	4	S.BUS2	12	12	12	20	20	20
SB2 / 5	5	5	5	S.BUS2	13	13	13	21	21	21
SB2 / 6	6	6	6	S.BUS2	14	14	14	22	22	22
SB2 / 7	7	7	S.BUS2	S.BUS2	15	15	S.BUS2	23	23	S.BUS2
SB / 8	8	S.BUS	S.BUS	S.BUS	16	S.BUS	S.BUS	24	S.BUS	S.BUS
LED blink	RED 1	RED 2	RED 3	RED 4	RED 5	GREEN 1	GREEN 2	GREEN 3	GREEN 4	GREEN 5

- Fixed a problem when connecting with DLPH-1/DLPH-2/FDLS-1 in dual RX link mode.
- Supports receiver settings from transmitter.

\*When using FASSTest26CH, be sure to update the receiver to V2.0.

\*T16IZS, T16IZ cannot operate after 17ch.

## V1.3 UPDATE

- Fixed the bug that F/S does not work when receiving error when FASSTest12ch telemetry OFF mode is used.
- Fixed a bug that the RPM display of the telemetry RPM sensor (SBS-01RM/RO/RB) did not become 0.
- Fixed the malfunction of the battery fail-safe setting CH when the battery fail-safe state occurred when using R9001SB and dual RX link mode.
- Fixed the operation response when using dual RX link mode with R9001SB in FASSTest12ch mode.

## V1.1 UPDATE

- Fixed an issue where some transmitters could not be linked.

Back of receiver



Receivers whose serial number is 2351 or earlier are eligible. Receivers from 2352 onwards do not need to be updated.