

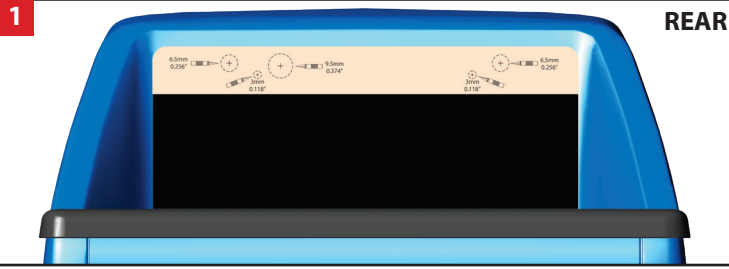

## LED Light Bar Kit Installation Instructions Addendum

Requires Part #7885; Covers Part #7693



**CAUTION: RISK OF INJURY!** Use care with hobby knives, tapered reamers, and other cutting tools as they are extremely sharp and can cause severe injury, deep cuts, and/or punctures.

### Body Modification

Install the included template on the truck body. Align the template with the rear window as shown. Using a tapered body reamer (part #3433 or 3433X, sold separately), carefully cut the holes in the truck body for the screw bosses on the rear LED light bar mount and the rear light bar connectors (note the hole diameters indicated on the templates and the corresponding diameter measurements on the body reamer).

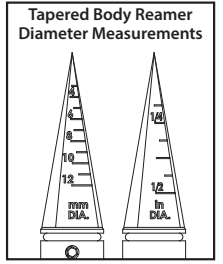

**2 X-MAXX** NOTE: Part #7885 LED light kit is required for complete installation. Once your truck body has been modified as shown in step 1, please refer to the X-Maxx instructions included in the #7885 LED light kit for installation steps 2-4; then, proceed to step 5 below.

**3 X-MAXX**

**4 X-MAXX**

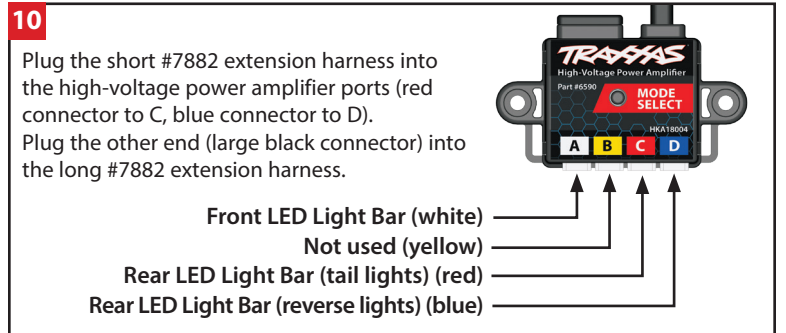
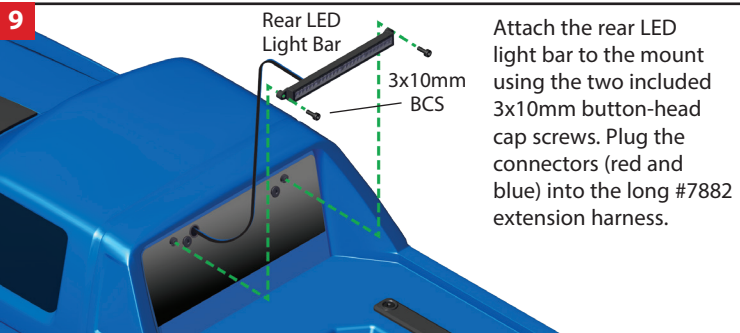
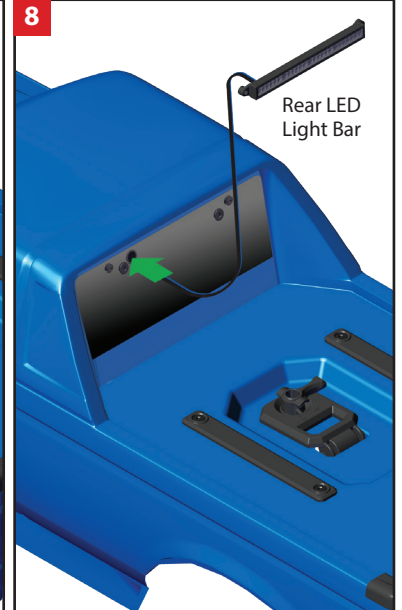
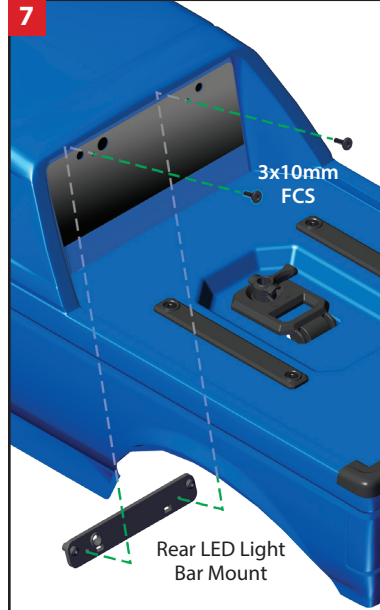
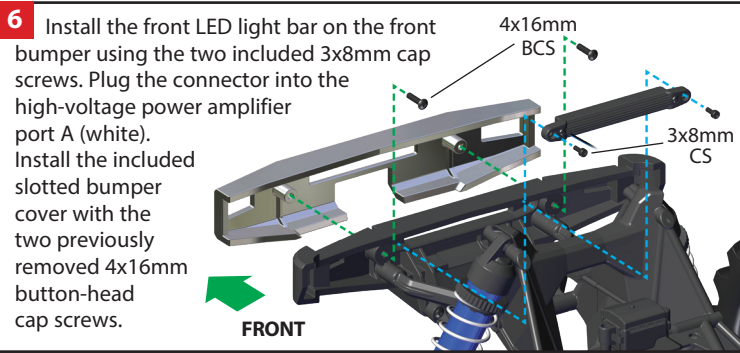
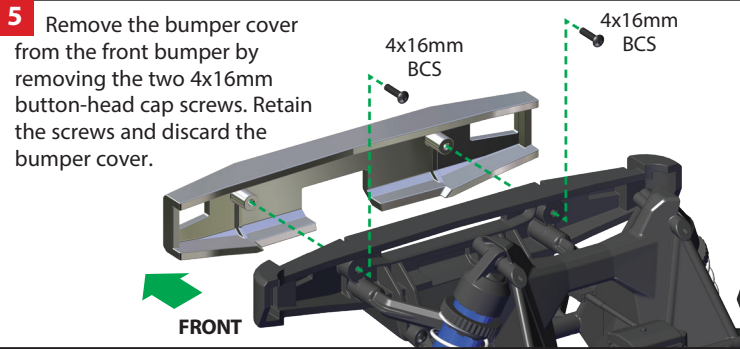

## 11 X-Maxx Wiring Diagram

Use the supplied zip ties to secure all wiring to the chassis.

